

HyDrain at Knysna Heads

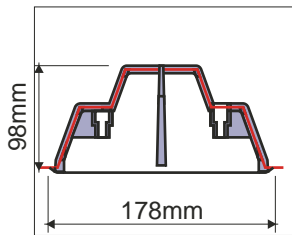

State of the Art & Won't Block Up

DOMES



FLANGE

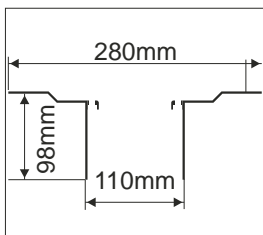

75 SIDE OUTLET

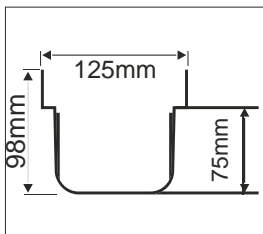

75 BOTTOM OUTLET

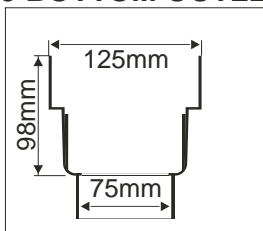

Features & Benefits

- Tough UV proof glass filled nylon dome
- Second Fix - flange with dome grate & flange
- Bottom or side outlet
- First Fix - F-Box in concrete with protective construction cover
- Accepts 'torch on' or cementitious water proofing
- Height adjustable water proofing flange
- Bolt Down grate for water tight seal

Product Description

A 'two fix' rain water drain for concrete flat roofs. The 110 x 75 mm side or bottom outlet F-Box with protective construction cover is set into the concrete slab. Flange has 110mm spigot which can also be fitted into standard 110mm straight socket or 110mm 95 degree elbow. Flange Height is set to the water proofing level after the concrete has set. Concrete surface is then water proofed covering the flange with bitumen or cementitious water proofing. Dome Grate is then bolted down onto water proofing membrane. A permanent water proof seal is provided for

Architects Specification

- Provide HyDrain to positions where roof drains are shown
- Set 75mm bottom or side outlet F-Box to 75mm PVC downpipe.
- Fit temporary protection cover during construction
- Fit Flange and set flush with waterproofing level
- Torch under side of bituminous water proofing membrane and dress onto flange
- Or paint cementitious sealer with fabric membrane onto flange
- Bolt down Dome Grate onto water proofing membrane with 4 brass bolts provided



HyDrain Flange is set to perfect height for waterproofing

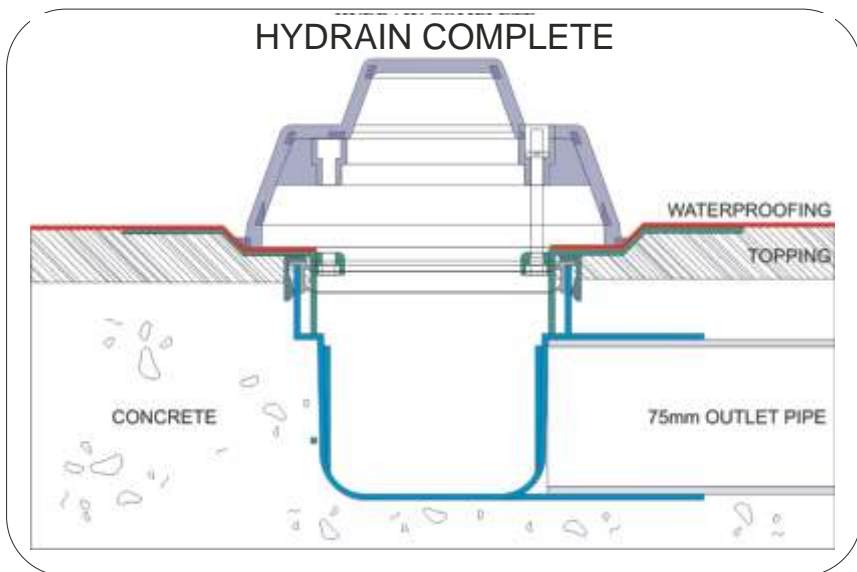

Height adjustable
Flange with
110mm Spigot

Products

HyDrain Second Fix - Grate & Flange

110mm Bottom Outlet
Fits all F-Boxes Below

097704



HyDrain Set - with
75mm Side Outlet

097802



HyDrain First Fix - F-Box



50mm Side
Outlet F-Box

097800



50mm Bottom
Outlet F-Box

097801



75mm Side
Outlet F-Box

097702



75mm Bottom
Outlet F-Box

097703

HyDrain F-Boxes are supplied with temporary protection covers for use during construction