



**GRS**  
GLOBAL ROOFING SOLUTIONS



**CORRUGATED**

---



## Typical specification

### Materials

The roofing/side-cladding shall be **Corrugated 10.5** material in 0.5 mm / 0.58 mm / 0.8 mm with a galvanised finish of Z275 or with a Globalcoat™ finish to one/two sides.

**Corrugated 10.5** shall be obtained from Global Roofing Solutions - HH Robertson Division, Telephone (011) 392 9800.

### The Profile

Shall be roll-formed with 10,5 corrugations at 76mm centres giving a nett cover of 762mm. The rib height shall be 17.5 mm.

### Embossing

Corrugated 10.5 sheeting can be embossed for thicknesses not less than 0,5mm. Embossing provides a quality textured finish to the sheet and reduces glare, minimises potentially unsightly "oil canning" and enhances the appearance of a metal clad building. Full Hard materials are available lightly embossed.

### Lengths

In general, the maximum length of **Corrugated 10.5** sheeting offered is 13.5 m. However, in the case of **Corrugated 10.5** sheeting with a Global-Duro finish, the maximum recommended length should not exceed 12,0 m for handling reasons.

### Roof Pitch

When using **Corrugated 10.5** sheeting, the recommended minimum pitch for roof slopes in excess of 15 m is 10° and for slopes less than 15 m is 7,5°.

### Bullnosing and Curving

Care must be taken when ordering bullnoses and curves as there are no broad or narrow flutes on a **Corrugated 10.5**

sheeting to differentiate between a normal or reverse bullnose. Two items must be clearly indicated on a **Corrugated 10.5** bullnose:

1. The position of the "lip up" or "lip down" on the sheet
2. The colour requirements.

### Flashings

Stop endings must be formed at the apex to form a dam and the pan turned down to form a drip. The roof sheeting shall be closed as necessary with purpose made flashings and poly closers where necessary. Flashings shall be fixed to roofing by means of No. 14 Topspeed Hex Head screws 25mm Lg with 26mm diameter bonded washers on roof and 19mm diameter bonded washers for side cladding.

### Versatile

**Corrugated 10.5** is available in stainless steel, aluminium, polycarbonate and translucent fibreglass sheeting. A full range of accessories includes flashings, fascias, gutters and downpipes.

### Site storage

All **Corrugated 10.5** sheets and accessories should be stored clear of the ground and protected from the elements and mechanical damage. Should the sheets become wet, it is essential that they be individually dried immediately to avoid staining and eventually white rust.

### Cleaning up

The **Corrugated 10.5** roofing, including gutters, must be handed over free of any debris.

### Quality assurance

The manufacturer shall be assessed and certified as complying with ISO 9001:2000 Quality Management System.

## Corrugated 10.5 profile

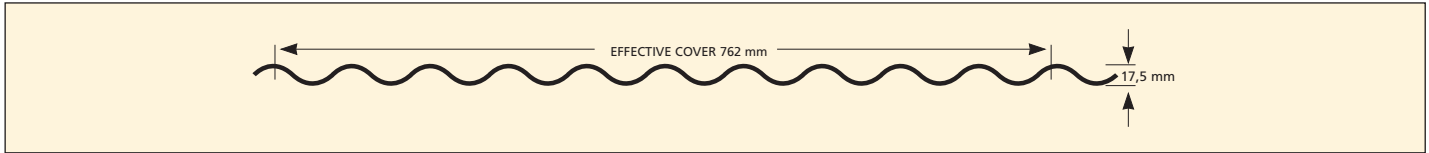

Maximum Allowable Support Spacings (mm)					
TYPE OF SPAN	GALVANISED			55% Aluminum-Zinc Alloy coated steel	
	0.5 mm ISQ 550	0.58 mm ISQ 300	0.8 mm ISQ 230	0.47 mm G550	0.53 mm G550
<b>Roofs</b>					
Single Span	600	600	1100	600	700
End Span	900	900	1200	900	1200
Internal Span	1100	1100	1350	1200	1500
Non-Stiffened Overhang	200	200	250	180	250
<b>Walls</b>					
Single Span	990	990	1300	1100	1500
End Span	1100	1100	1400	1250	1800
Internal Span	1500	1500	1800	1700	2400
Overhang	200	200	280	150	200
Normal mass kg/m <sup>2</sup>	5.03	5.86	7.92	4.61	5.22

## Assembly

The sheeting shall be laid with side-laps on the leeward side of the prevailing wind direction and placed in position to give 1,5 corrugations side-lap. An approved side-lap sealant shall be incorporated on roofing with a pitch less than 15 degrees. All fixing holes shall be drilled and not punched. Roof sheets shall be fixed by means of No. 14 Topspeed Hex screws 50 mm long for steel or 65 mm long for timber purlins and shall incorporate 26 mm diameter bonded washers. Side-lap stitching shall be effected at no more than 600 mm centres with 25 mm long Topspeed Hex Head screws. Side cladding shall be fixed by means of No. 14 Topspeed Hex Head screws 25 mm long for steel girts or 50 mm long for timber girts and shall incorporate 19 mm diameter bonded washers.

For roofs allow a minimum end lap of 230 mm between 10° and 15° pitch and 150 mm above 15°. For walls allow a minimum end lap of 100 mm.

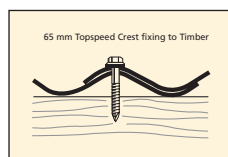
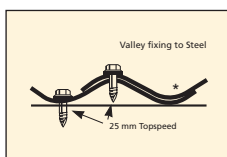
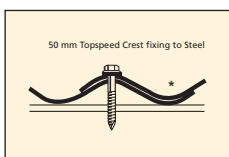
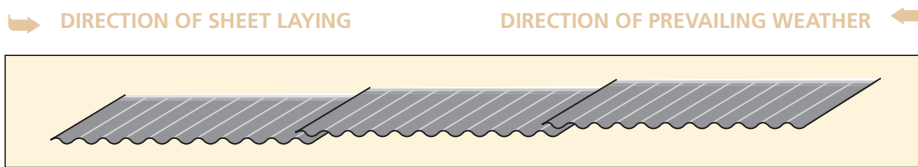

**\*DO NOT place fastener in this valley.** Leakage through underlap will result if pierced.

**NOTE: Do not over-tighten screws.** Drive screw until slight deformation is just visible at crest of rib.

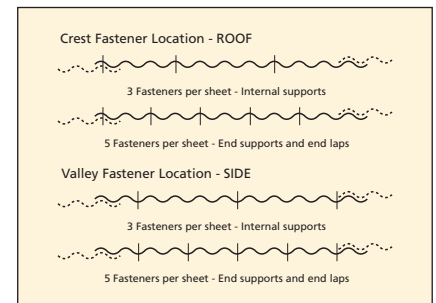

## Fastener holes

Do not use punches to form fastener holes. Use correct size drill to suit fastener, or self-drilling screws where applicable.

### Sidewall Flashing

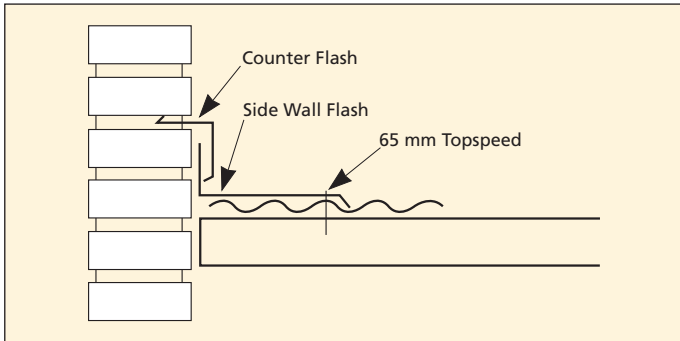

### Headwall Flashing

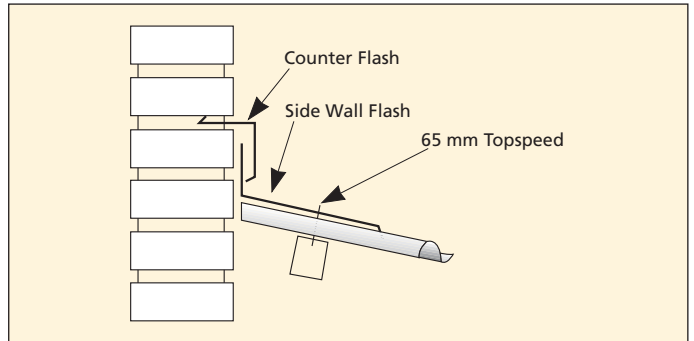

### Ridge Flashing

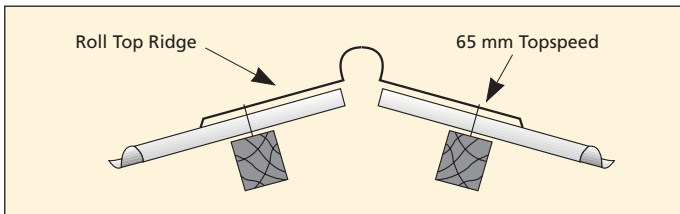

### Gutter Detail

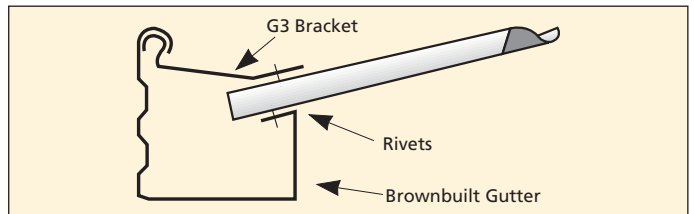

### Valley Flashing

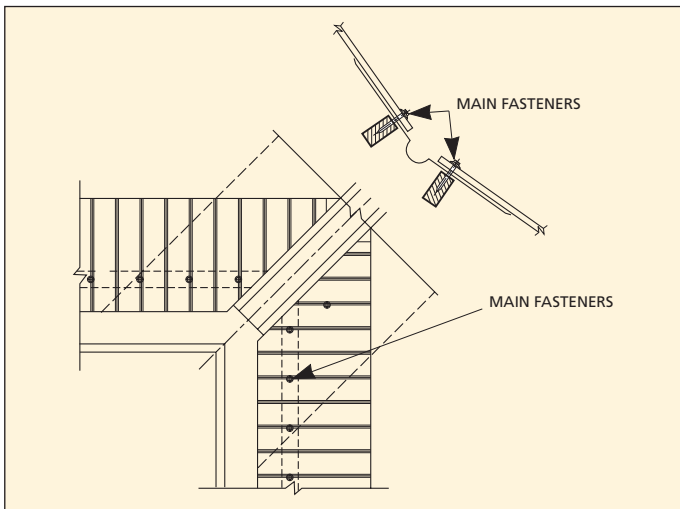

### Gable Flashing

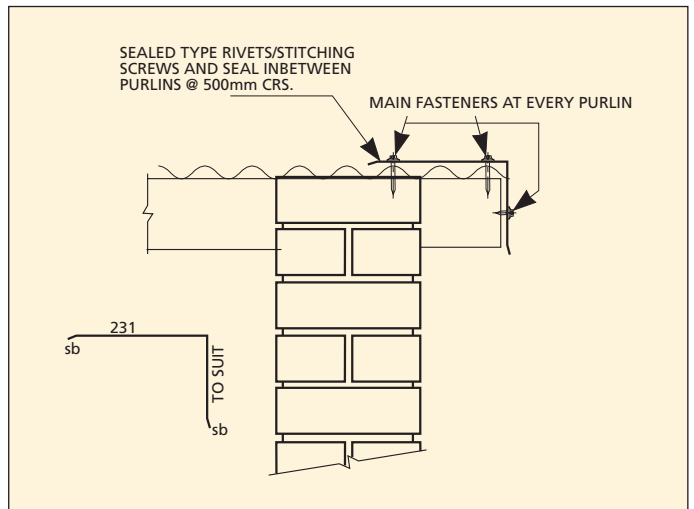

**GRS**  
GLOBAL ROOFING SOLUTIONS

#### Global Roofing Solutions Corporate:

Head Office: Tel: +27 11 570 4600 Fax: +27 11 974 5683  
Brownbuilt: Tel: +27 11 898 2900 Fax: +27 11 892 1455  
HHRobertson Tel: +27 11 392 9800 Fax: +27 11 392 2230

#### Global Roofing Solutions Branches:

Cape Town Tel: (021) 521 1900 Fax: (021) 556 6936  
Durban Tel: (031) 700 1414 Fax: (031) 700 1455  
East London Tel: (043) 731 2530 Fax: (043) 731 1795  
Bloemfontein Tel: (051) 432 3724/6 Fax: (051) 432 3723